

Stražilovska ulica

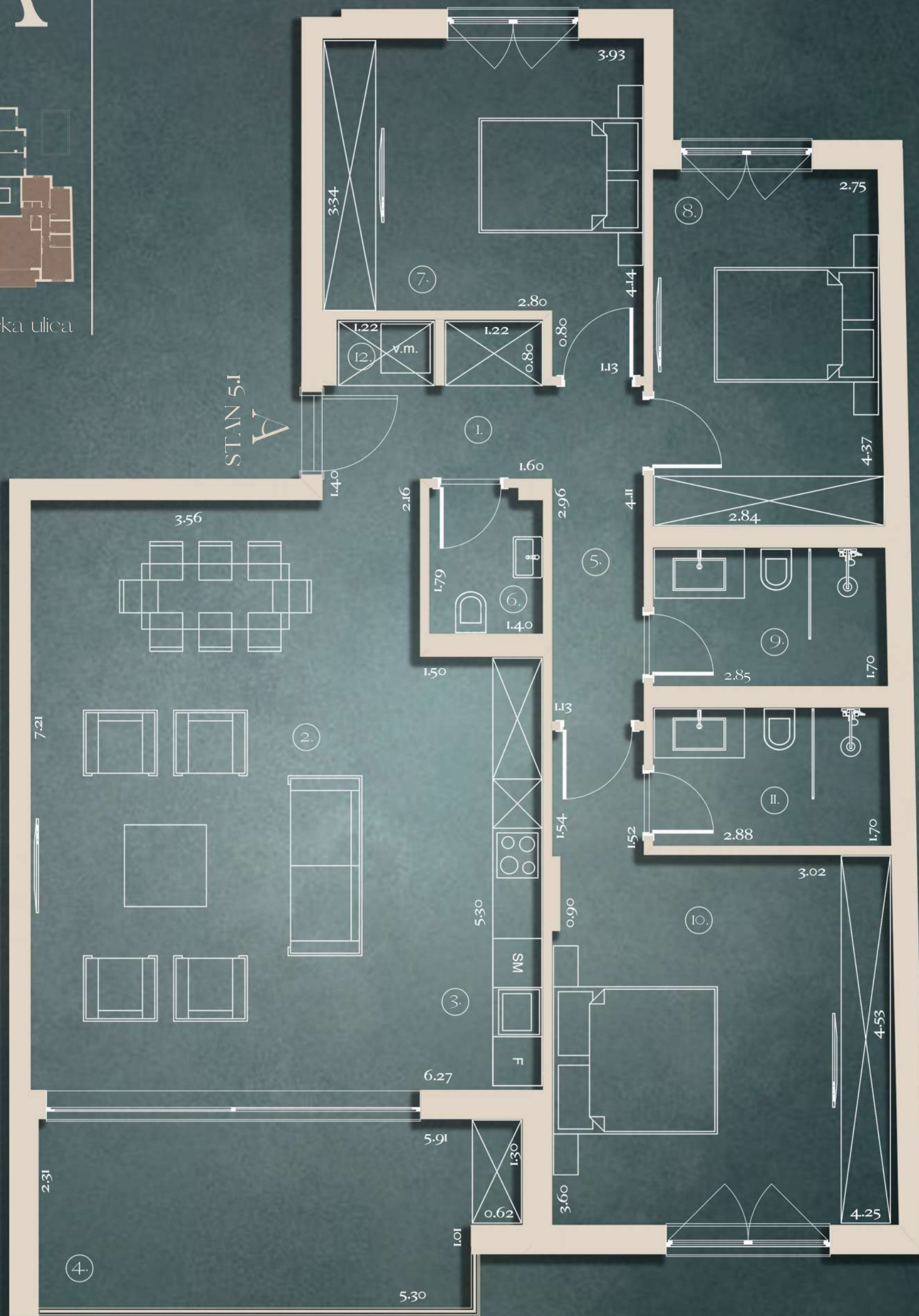

Radnička ulica



STAN 5.1  
A

## STAN 5.1 125.36 m<sup>2</sup>

1. Hodnik	4.50 m <sup>2</sup>	7. Spavaća soba	14.03 m <sup>2</sup>
2. Dnevna soba	34.38 m <sup>2</sup>	8. Spavaća soba	12.23 m <sup>2</sup>
3. Kuhinja	7.95 m <sup>2</sup>	9. Kupatilo	4.88 m <sup>2</sup>
4. Terasa	13.65 m <sup>2</sup>	10. Master soba	20.70 m <sup>2</sup>
5. Degažman	4.65 m <sup>2</sup>	11. Master kupatilo	4.94 m <sup>2</sup>
6. Toalet	2.47 m <sup>2</sup>	12. Utility	0.98 m <sup>2</sup>